

## 4/25 Elizabeth Bay Road Elizabeth Bay, NSW

1 bed | 1 bath

Positioned on one of Sydney's most desirable streets, this charming Art-Deco apartment is set within a well-maintained boutique strata building and presents a superb opportunity for both investors and owner-occupiers.

Filled with natural light and enjoying a pleasant leafy outlook, the approximately 40sqm residence showcases classic period character including high ornate ceilings and generous proportions throughout. Its unique layout allows for use as either a spacious one-bedroom apartment or an oversized studio, offering flexibility to suit a range of lifestyles.

...

# R&W

[rwebay.com.au/8630604](http://rwebay.com.au/8630604)

Angelo Bouras 0401 658 653

Alex Mulholland 0410421182

**Proudly Richardson&Wrench**

Richardson & Wrench Elizabeth Bay / Potts Point  
02 8356 2700

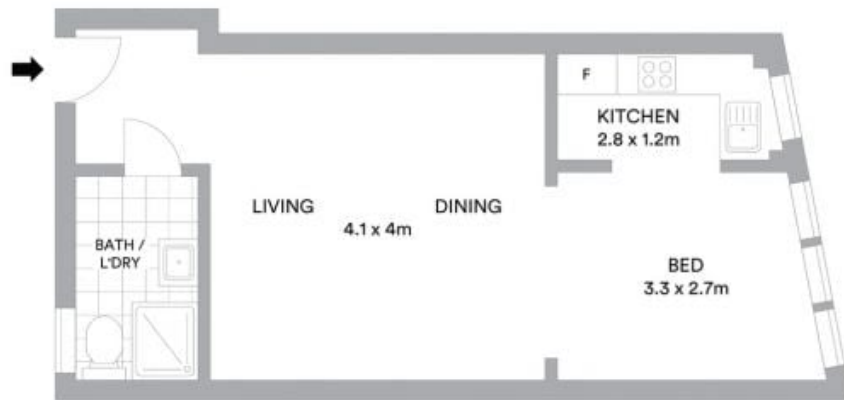

LOWER GROUND FLOOR



Scale in metres. Indicative only. All information contained herein is obtained from sources we believe to be accurate. We cannot guarantee its accuracy. Interested persons should make and rely on their own enquiries