



216/50 Macleay Street Potts Point, NSW

1 bed | 1 bath

Set in the heart of cosmopolitan Potts Point, this oversized one-bedroom apartment in the prestigious 'Rex' building has been meticulously renovated to deliver modern elegance and everyday comfort. Offering a peaceful leafy outlook while just moments from caf?s, dining, and transport, it's a stylish sanctuary in one of Sydney's most vibrant lifestyle precincts.

? Oversized one-bedroom apartment with leafy outlook

Approximate Outgoings:...

R&W

rwebay.com.au/8644403

Angelo Bouras 0401 658 653

Alex Mulholland 0410421182

Proudly Richardson&Wrench

Richardson & Wrench Elizabeth Bay / Potts Point
02 8356 2700

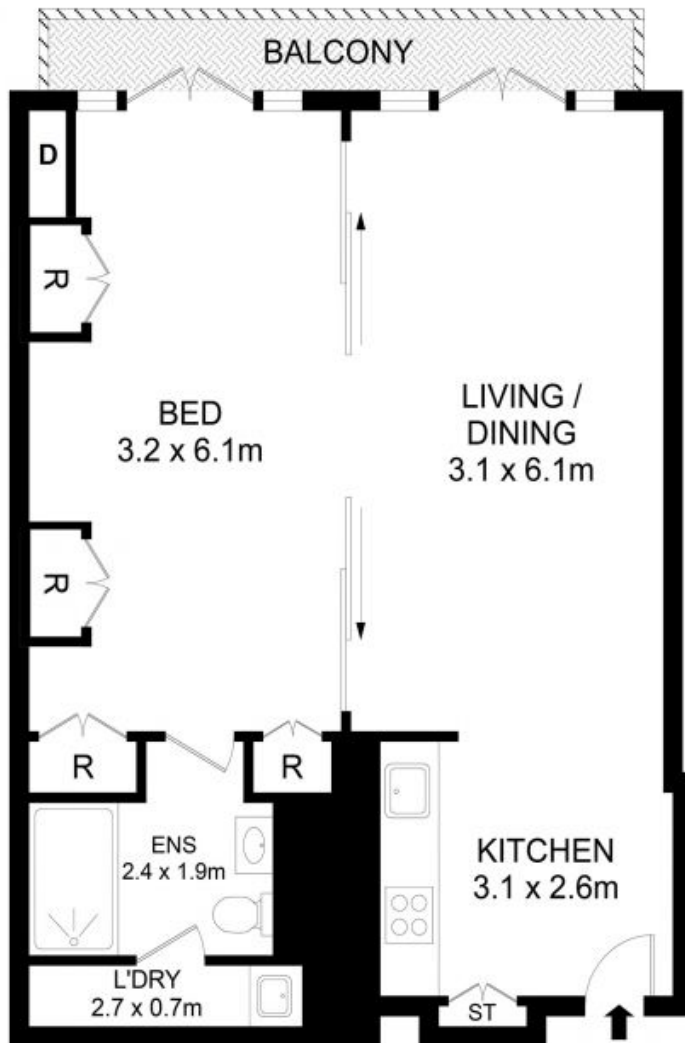

216/50 Macleay Street, Potts Point



Disclaimer

Floor Plan measurements are approximate and are for illustrative purposes only. While we cannot doubt the floor plans accuracy, we make no guarantee, warranty or representation as to the accuracy and completeness of the floor plan.

Every precaution has been taken to establish accuracy of the information in this brochure but does not constitute any representation by the vendor or agent.