



6/75 Elizabeth Bay Road Elizabeth Bay, NSW

2 bed | 1 bath

Enjoying a sought-after waterfront position and view in the tightly held Engleham, this light-filled two-bedroom apartment overlooks Rushcutters Bay and offers level access from the building's front door to the apartment. Set back from the exclusive Elizabeth Bay Road 'loop' the apartment is peacefully positioned and exceptionally convenient, and only a short walk to Rushcutters Bay Park, the Cruising Yacht Club of Australia, caf?s, shops and transport.

Inside, the apartment is bright and inviting, with poli...

R&W

Open Thursday, 21st May 2026 10:00 - 10:30

[rwebay.com.au/8662094](https://www.rwebay.com.au/8662094)

Penny Timothy 0418 546 500

Luke McDonnell 0418 844 110

Proudly Richardson&Wrench

Richardson & Wrench Elizabeth Bay / Potts Point
02 8356 2700

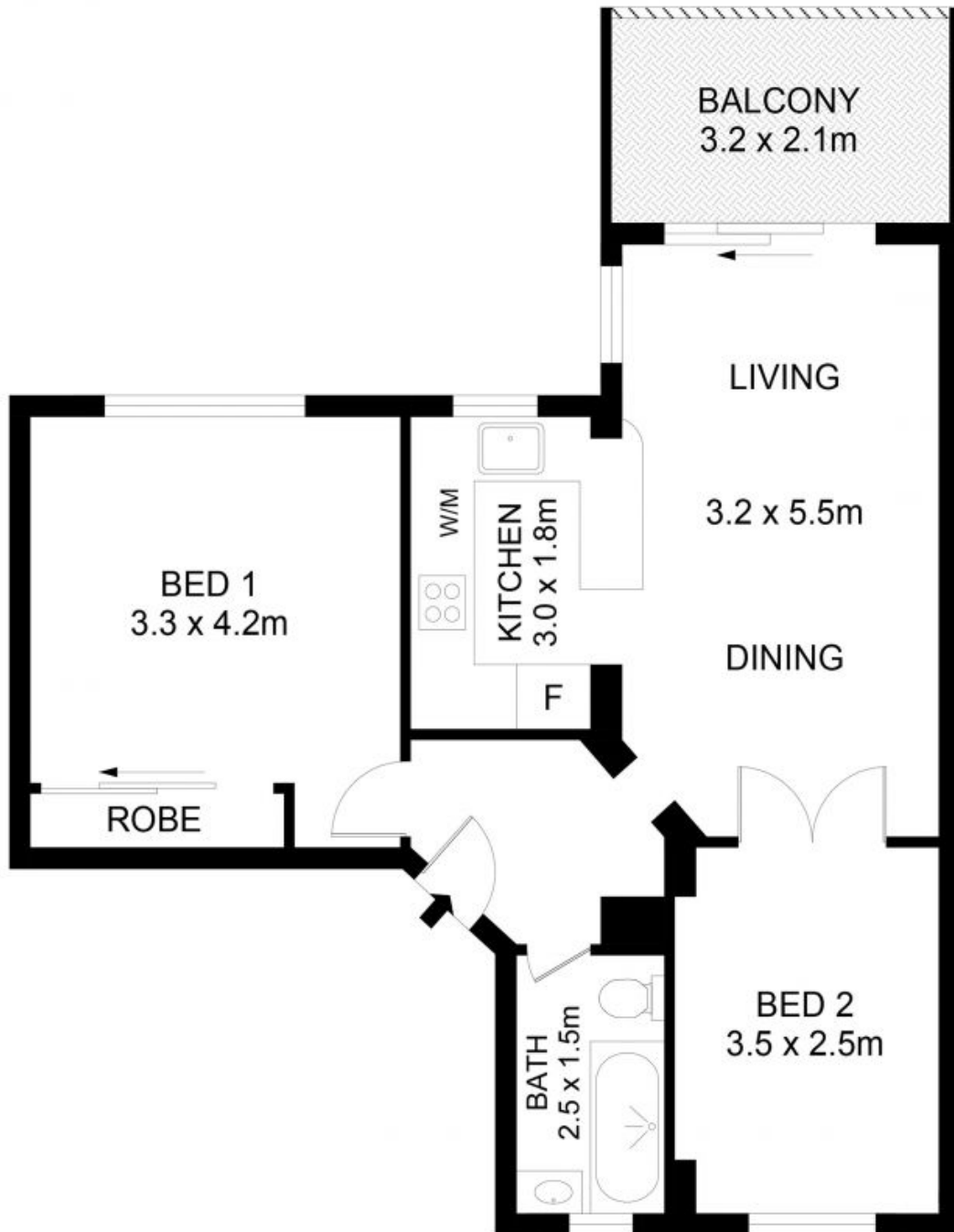

6/75 Elizabeth Bay Road, Elizabeth Bay

Disclaimer

Floor Plan measurements are approximate and are for illustrative purposes only. While we cannot doubt the floor plans accuracy, we make no guarantee, warranty or representation as to the accuracy and completeness of the floor plan.