



G11/2a Elizabeth Bay Road Elizabeth Bay, NSW

1 bed | 1 bath

Delivering effortless indoor-outdoor living in a premier Elizabeth Bay setting, this stylish courtyard apartment offers privacy, convenience and low-maintenance appeal within the iconic Gazebo building. Featuring its own private entrance from Baroda Street, the home presents as an ideal city retreat, investment or downsizer opportunity just moments from Potts Point's vibrant dining and lifestyle scene.

Spanning approx. 53sqm, the apartment showcases fresh m...

R&W

Auction Thursday, 14th May 5:30

R&W Offices, Shop 2/75 Macleay St, Potts Point

Open Saturday, 18th April 2026 1:45 - 2:15

rwebay.com.au/8674414

Angelo Bouras 0401 658 653

Alex Mulholland 0410421182

Proudly Richardson&Wrench

Richardson & Wrench Elizabeth Bay / Potts Point
02 8356 2700

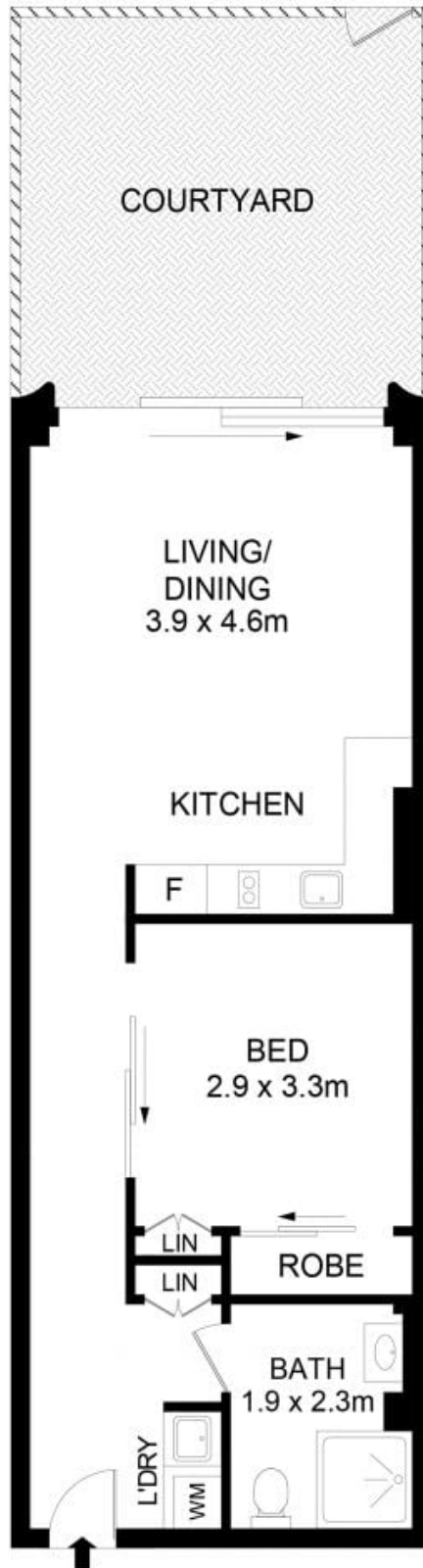
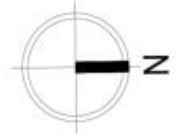

G11/2A Elizabeth Bay Road, Elizabeth bay

Disclaimer

Floor Plan measurements are approximate and are for illustrative purposes only. While we cannot doubt the floor plans accuracy, we make no guarantee, warranty or representation as to the accuracy and completeness of the floor plan.