



22/7 St Neot Avenue Potts Point, NSW

1 bed | 1 bath

Set in a quiet, tree-lined street, "Parkview" is a well-kept 1930s Art Deco building of 23 apartments.

Located on the top floor, this studio offers a leafy outlook and a practical open-plan layout with a built-in wardrobe. The balcony provides a nice outdoor space, and there is access to a common laundry and shared rooftop with great views.

Features:

Images have been virtually staged....

R&W

rwebay.com.au/8674938

Zoe Mallinder 0410 808 384

R&W Leasing 02 8356 2700

Proudly Richardson&Wrench

Richardson & Wrench Elizabeth Bay / Potts Point
02 8356 2700

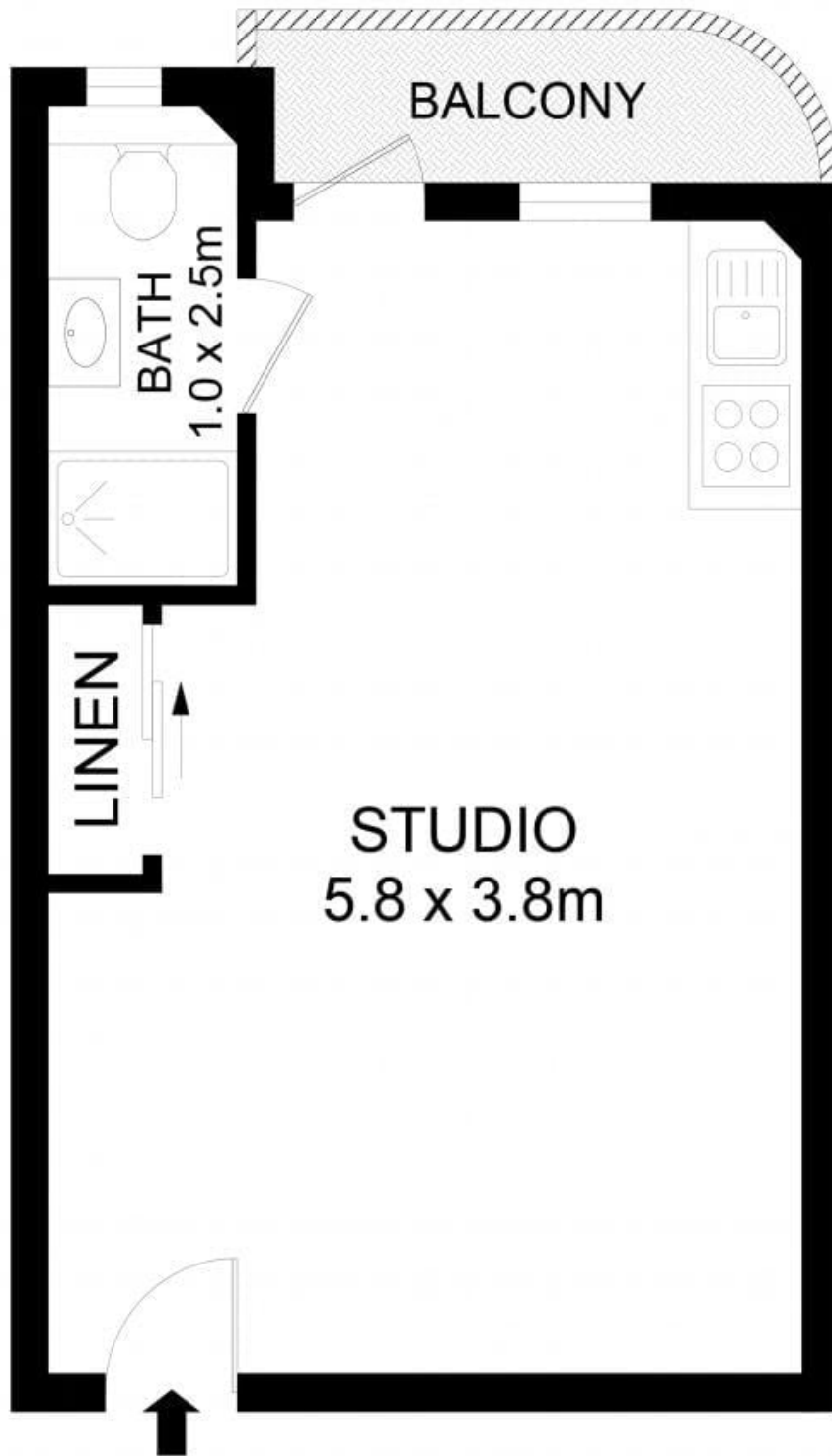

22/7 St Neot Avenue, Potts Point.

Disclaimer

Floor Plan measurements are approximate and are for illustrative purposes only. While we cannot doubt the floor plans accuracy, we make no guarantee, warranty or representation as to the accuracy and completeness of the floor plan.

Every precaution has been taken to establish accuracy of the information in this brochure but does not constitute any representation by the vendor or agent.

