



43/17 Wylde Street Potts Point, NSW

2 bed | 1 bath

R&W

Positioned on Level 4 of the iconic 1951 Aaron Bolot-designed building, this two-bedroom apartment blends timeless architectural character with contemporary comfort. Framed by wall-to-wall windows and enjoying a peaceful treetop outlook, the residence is filled with natural light from its desirable east and north-facing aspects.

Set within a nationally significant post-war internatio...

Auction Thursday, 14th May 5:30
R&W Offices, Shop 2/75 Macleay St, Potts Point
[ebay.com.au/8675406](https://www.ebay.com.au/8675406)

Angelo Bouras 0401 658 653
Greg McKinley 0412 044 822

Proudly Richardson&Wrench

Richardson & Wrench Elizabeth Bay / Potts Point
02 8356 2700

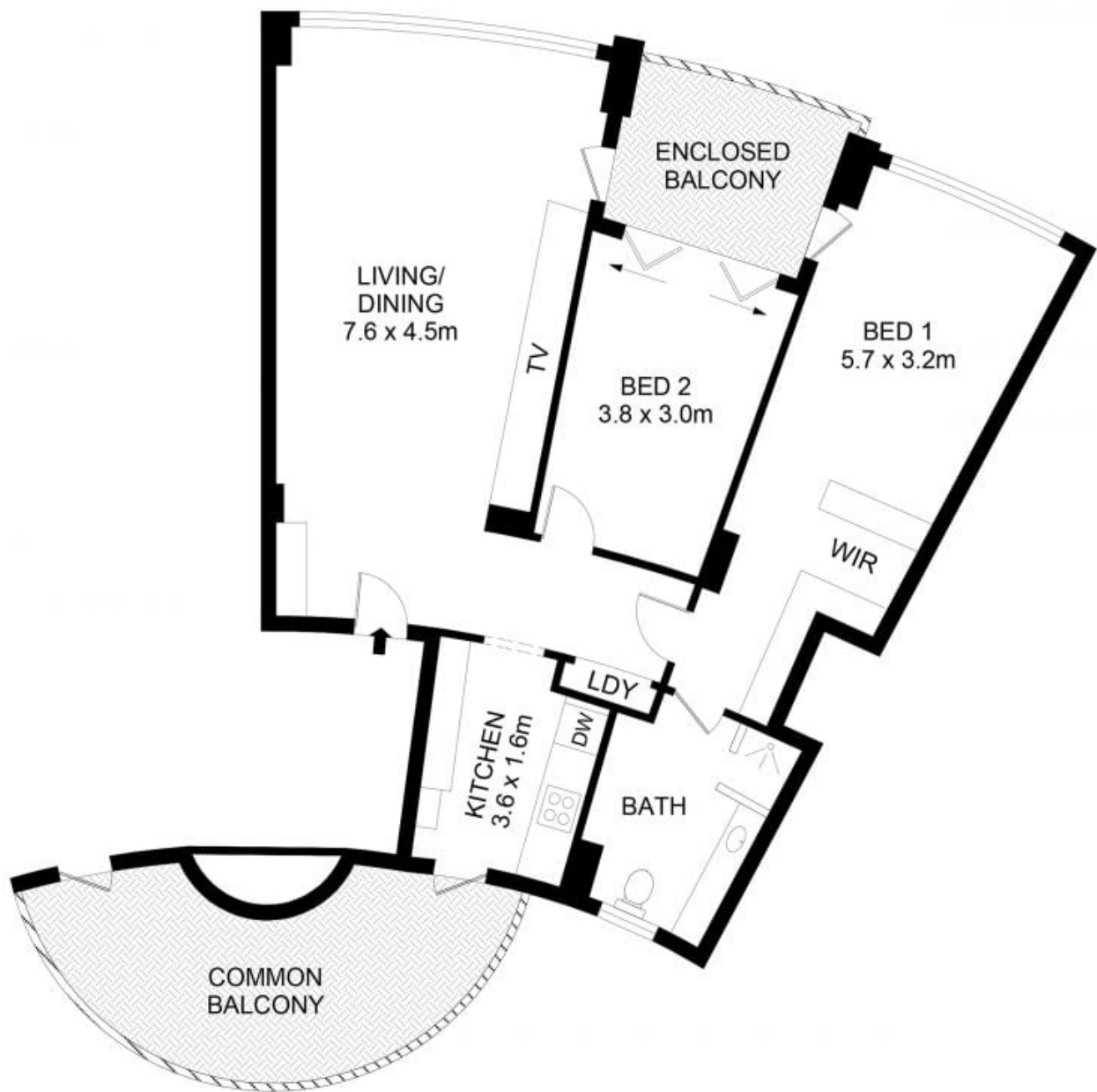

43/17 Wylde Street, Potts Point



Disclaimer

Floor Plan measurements are approximate and are for illustrative purposes only. While we cannot doubt the floor plans accuracy, we make no guarantee, warranty or representation as to the accuracy and completeness of the floor plan.

Every precaution has been taken to establish accuracy of the information in this brochure but does not constitute any representation by the vendor or agent.

R&W