



## 411/46a Macleay Street Potts Point, NSW

- > Level 4 suite in the renowned BKH designed "Post" complex.
- > 65sqm approx. strata area.
- > Open plan space recently reconfigured / renovated
- > Offered with Vacant Possession.
- > Perfect HQ for an owner occupier /SMSF
- > Proven rental returns for investors
- > Renovated kitchen, internal bathroom, and reverse cycle air conditioning
- > Superb location in the heart of Potts Point ? walk to Kings Cross train station & CBD

# R&W

[rwebay.com.au/8689193](http://rwebay.com.au/8689193)

Andrew Hoggett 0412 208 614

James Hoggett 0438 247 336

Greg McKinley 0412 044 822

**Proudly Richardson&Wrench**

Richardson & Wrench Elizabeth Bay / Potts Point  
02 8356 2700



Elizabeth Bay  
TEL: 02 8356 2700

411/46a Macleay Street  
POTTS POINT

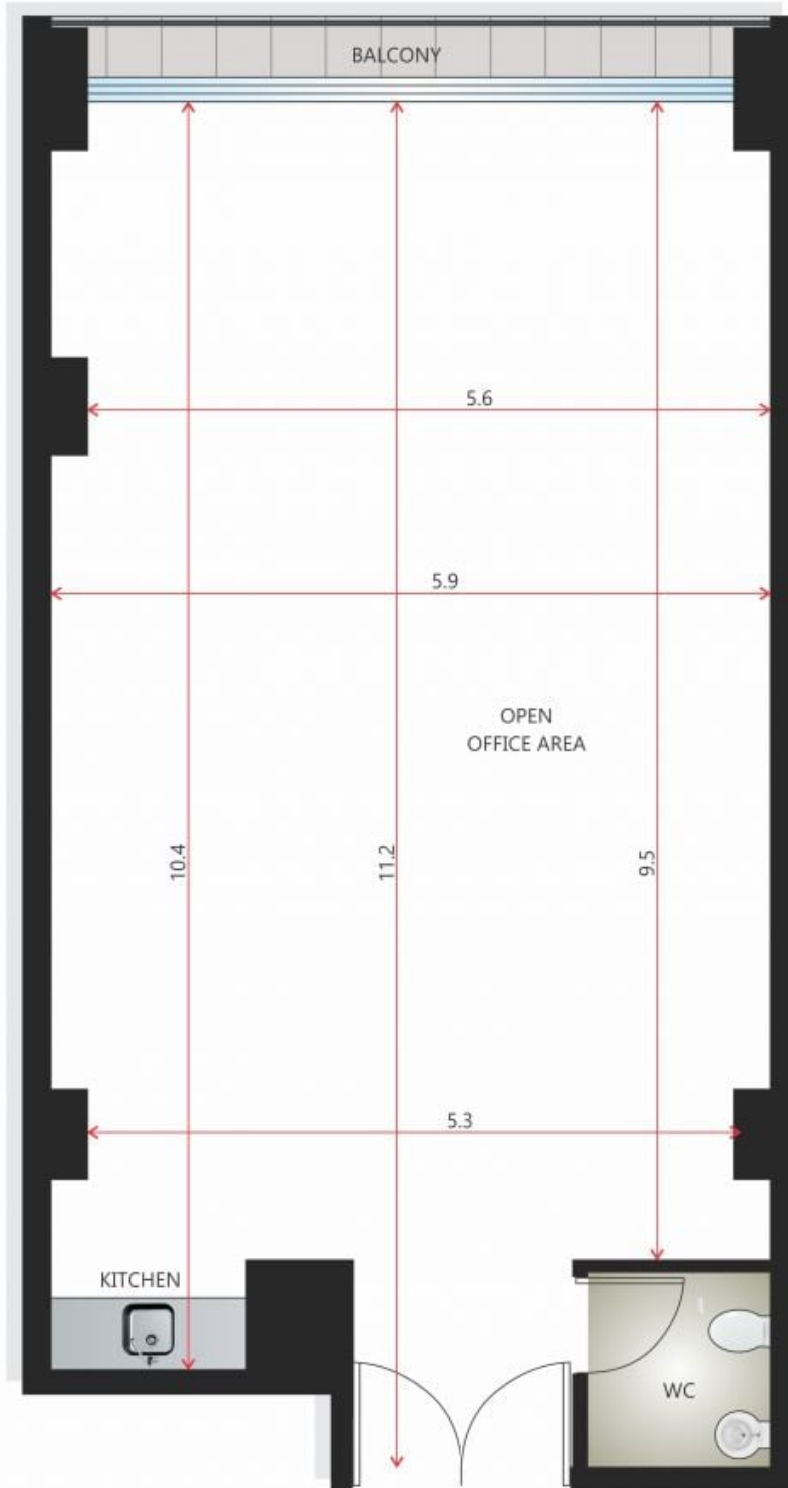

FLOOR PLAN BY BORTEX PTY LTD PH: 0414 922 679

"The information contained herein has been provided by our Principal and third parties, which we merely pass on without any representation or warranty given, intended or implied by us as to its correctness and with no liability accepted by us in this regard. You must rely on your own inquiries as to its accuracy or otherwise."

Every precaution has been taken to establish accuracy of the information in this brochure but does not constitute any representation by the vendor or agent.

