



12/1 McDonald Street Potts Point, NSW

| 1 bath

Positioned in one of Potts Point's most connected lifestyle pockets, this smartly updated studio apartment delivers effortless inner-city living with stylish modern updates and a highly functional layout. Move-in ready, the home features fresh contemporary interiors, An updated kitchen and bathroom, and excellent natural light throughout, making it an ideal city base, first home or investment opportunity just moments from Macleay Street village, Woolloomooloo waterfront and the CBD.

Approximate outgoings:...

R&W

Open Saturday, 23rd May 2026 10:00 - 10:30

[rwebay.com.au/8709557](https://www.rwebay.com.au/8709557)

Luke McDonnell 0418 844 110

Penny Timothy 0418 546 500

Proudly Richardson&Wrench

Richardson & Wrench Elizabeth Bay / Potts Point
02 8356 2700

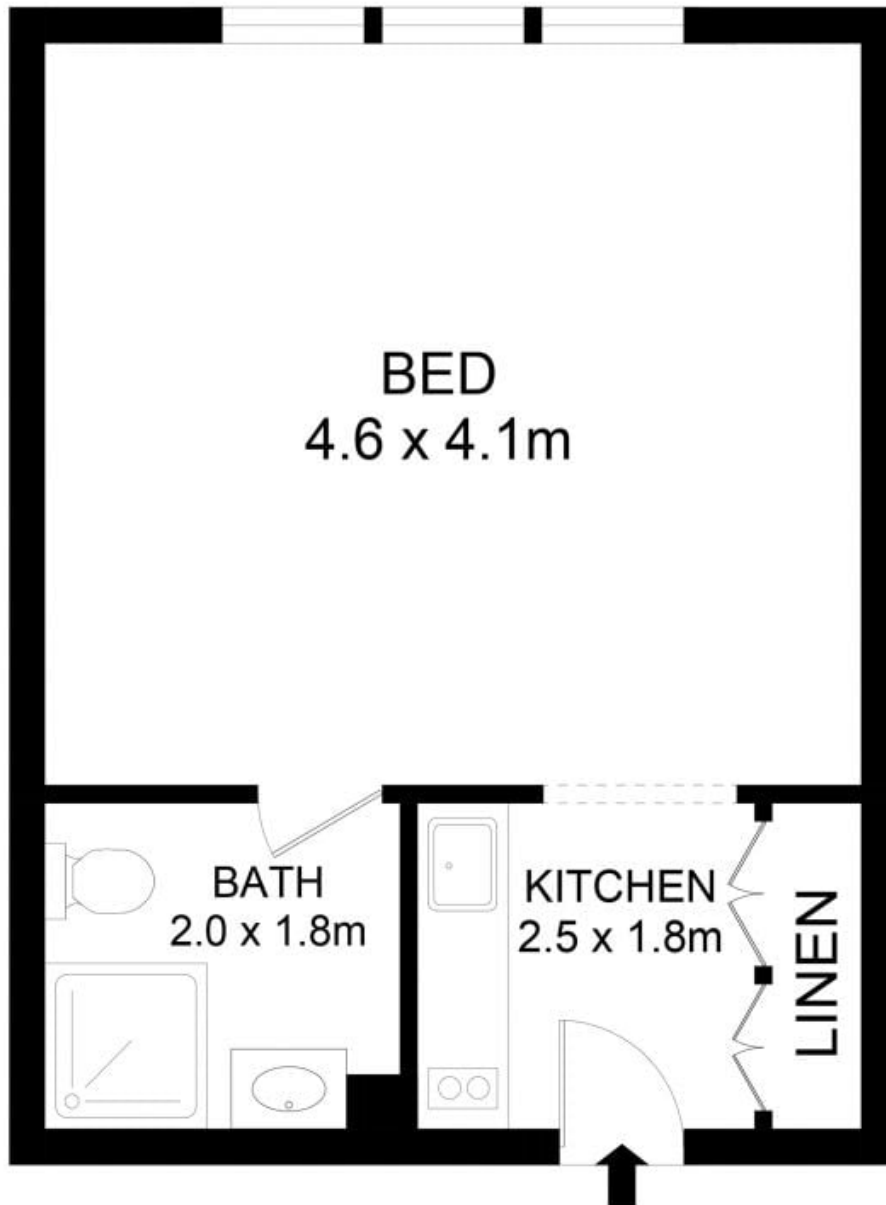
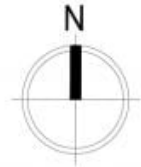

12/1 McDonald Street, Potts Point

Disclaimer

Floor Plan measurements are approximate and are for illustrative purposes only. While we cannot doubt the floor plans accuracy, we make no guarantee, warranty or representation as to the accuracy and completeness of the floor plan

Every precaution has been taken to establish accuracy of the information in this brochure but does not constitute any representation by the vendor or agent.

