



## 19/50 Bayswater Road Rushcutters Bay, NSW

2 bed | 1 bath

Set within the beautifully refurbished landmark building 'Fiducia', this exceptional residence seamlessly combines the grandeur of its c1890s origins with sophisticated contemporary design. Reimagined by acclaimed interior designer Daniel Boddam, the apartment honours its heritage character while introducing a refined New York-inspired aesthetic.

Positioned in one of Rushcutters Bay's most sought-after...

# R&W

**Auction Monday, 22nd June 5:30**

**R&W Offices, Shop 2/75 Macleay St, Potts Point**

Open Saturday, 6th June 2026 9:15 - 9:45

**[rwebay.com.au/8718594](http://rwebay.com.au/8718594)**

Angelo Bouras 0401 658 653

Alex Mulholland 0410421182

**Proudly Richardson&Wrench**

Richardson & Wrench Elizabeth Bay / Potts Point  
02 8356 2700

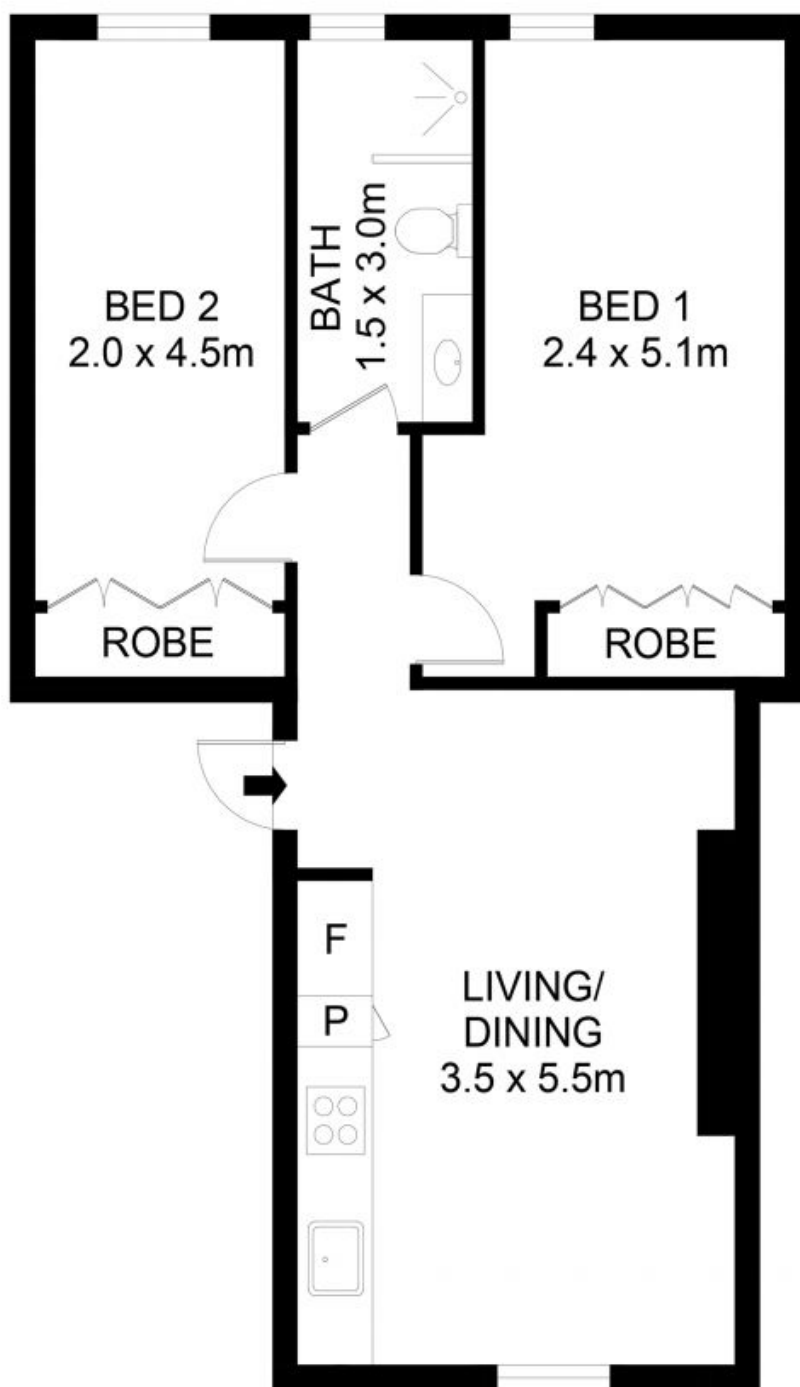

## 19/50 Bayswater Road, Rushcutters Bay

### Disclaimer

Floor Plan measurements are approximate and are for illustrative purposes only. While we cannot doubt the floor plans accuracy, we make no guarantee, warranty or representation as to the accuracy and completeness of the floor plan.