



## 10/7 Greenknowe Avenue Elizabeth Bay, NSW

| 1 bath

Positioned on level one of the tightly held Art Deco building 'Seven', this beautifully presented studio apartment offers an outstanding opportunity to secure a foothold in one of Sydney's most sought-after lifestyle precincts. Enjoying a prized north-facing aspect, the apartment is bathed in natural light and combines timeless character with low-maintenance modern living.

Polished timber floors, high ceilings and wide windows ...

# R&W

Open Saturday, 13th June 2026 11:30 - 12:00

[rwebay.com.au/8723825](https://www.rwebay.com.au/8723825)

Angelo Bouras 0401 658 653

Alex Mulholland 0410421182

**Proudly Richardson&Wrench**

Richardson & Wrench Elizabeth Bay / Potts Point  
02 8356 2700

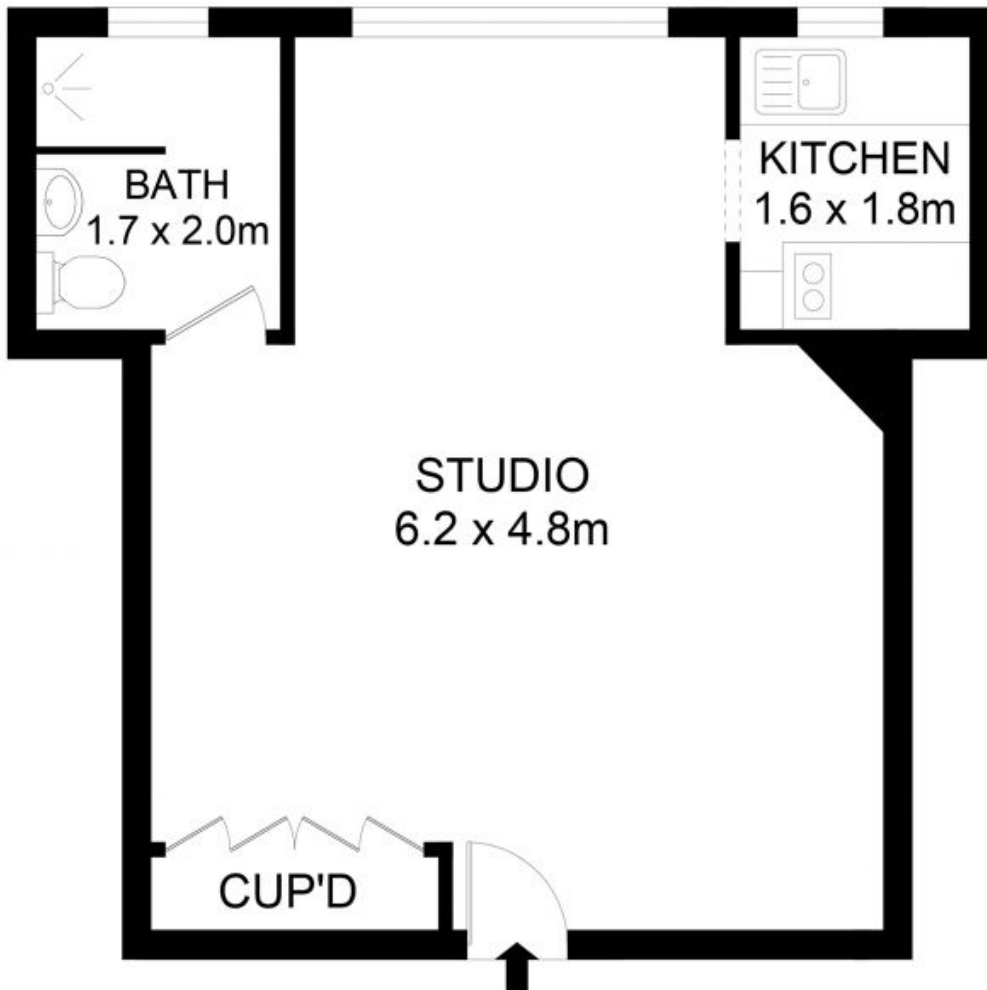
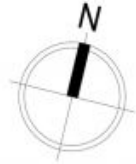

10/7 Greenknowe Avenue, Elizabeth Bay

**Disclaimer**

Floor Plan measurements are approximate and are for illustrative purposes only. While we cannot doubt the floor plans accuracy, we make no guarantee, warranty or representation as to the accuracy and completeness of the floor plan.

Every precaution has been taken to establish accuracy of the information in this brochure but does not constitute any representation by the vendor or agent.

**R&W**